



**€395,000**

**Ref: BL1103**

**84 sqm**

In São Martinho do Porto, 24 apartments will soon be built spread across two independent 3-storey buildings, with contem...

**Telephone: +351 213 471 603**  
**Email: [info@portugalhomes.com](mailto:info@portugalhomes.com)**

Praça da Alegria 1, 3rd Floor, 1250-004 Lisboa, Portugal Licence AMI - 14414 | APEMIP 5940



## Property Description

In São Martinho do Porto, 24 apartments will soon be built spread across two independent 3-storey buildings, with contemporary design, each offering stunning views of the sea and blending perfectly with the natural landscape. The T2 and T3 apartments will enjoy open-plan layouts and large windows that invite an abundance of natural light and the gentle sea breeze, creating a serene and inviting environment, space for parking in the basement and a communal swimming pool. Prices range from 395 000€ to 541 000€, depending on type and floor. São Martinho Bay is actually a natural amphitheater, not only because it provides a picturesque setting for leisurely days at the beach, but also because it offers countless opportunities for exploration and adventure. From fishing to bird watching, mountain biking, a leisurely stroll or a challenging walk along the picturesque trails, rugged coastline or enjoying the scenic viewpoints, you will always be rewarded with stunning views and a deep sense of connection with nature. São Martinho do Porto is ageless and a feast for the senses! Contact us for more information or to visit the location and take advantage of the launch prices! Energy Rating: A #ref:BL1103



## Gallery

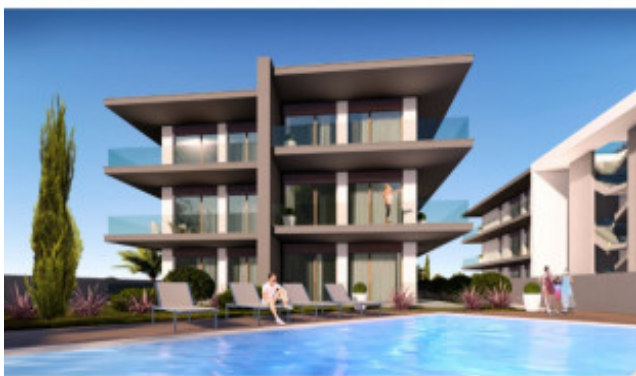

Telephone: +351 213 471 603  
Email: [info@portugalhomes.com](mailto:info@portugalhomes.com)

Praça da Alegria 1, 3rd Floor, 1250-004 Lisboa, Portugal Licence AMI - 14414 | APEMIP 5940

## Additional Details

**Telephone:** +351 213 471 603  
**Email:** [info@portugalhomes.com](mailto:info@portugalhomes.com)

Praça da Alegria 1, 3rd Floor, 1250-004 Lisboa, Portugal Licence AMI - 14414 | APEMIP 5940



## Site Floorplan

**Telephone:** +351 213 471 603  
**Email:** [info@portugalhomes.com](mailto:info@portugalhomes.com)

Praça da Alegria 1, 3rd Floor, 1250-004 Lisboa, Portugal Licence AMI - 14414 | APEMIP 5940

